

## The Parish Hall

Ringsend has a history of boat building, due to its unique promontory location at the mouths of the Dodder and Liffey Rivers. This tradition continued up to very recently, with many families in the area having members with a boat-building heritage. Timber boat building crafts, techniques and forms have often been the inspiration for building design over the centuries.



Indeed, the word nave comes from the Latin for ship, *navis*, a great example of which is the roof of St. Patrick's Church itself, which looks on the inside like an upturned ship. This has been interpreted in many wonderful ways, right up to modern days, making structurally efficient roofs with beautiful interiors.



This is an inspiration for the form of the new Parish Hall. The new Parish Hall will have a curved roof, wooden on the inside, and covered in green copper on the outside, like the hull of a copper-bottomed boat.

### Why is the new Building the shape it is?

1. The barrel vaulted roof gives a great feeling of space in the parish hall

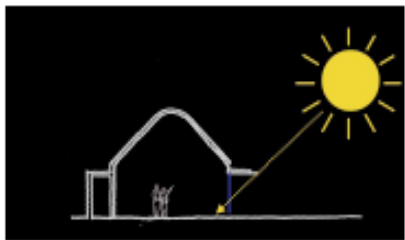

2. South facing windows to the Parish Hall overlook the Church garden. An open-air colonnaded canopy on the south side gives shading and prevents summer-time overheating of the hall, also providing an outdoor sheltered area.

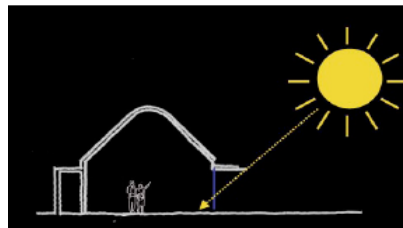

3. North facing skylights are integrated into the roof on the north side. This will provide good natural daylight for the hall, and will ensure that that the hall will not overheat due to direct sun from the south.

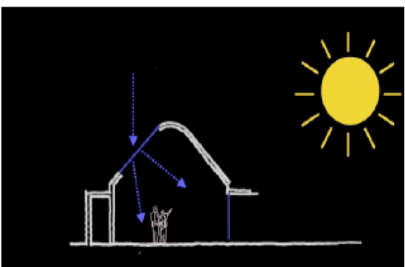

4. The roof is pitched at a suitable angle to retrofit solar panels to the south side of the roof at some future date.

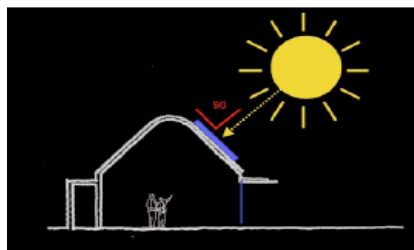

# Special Bulletin

Issue No. 06 A / 2011 (012A)

**St Patrick's Parish, Ringsend & Irishtown**

**Saturday 5<sup>th</sup> / Sunday 6<sup>th</sup> February 2011**



Parish Office: 01 6697429 - Opening Hours: 9.30 to 13.30 – Monday to Wednesday

## Proposed Parish Hall and Office

As beautiful as our church is it has always lacked the facilities that our parishioners / community need. During Fr Coady's time as Parish Priest permission was sought from Archbishop's House for the construction of a Parish Hall and Parish Office. Permission was given in 2009 to proceed and the Parish Council began the process of identifying the needs of the parishioners which they put into a brief for an architect. When this process was complete the Parish Council approached a couple of architects with the brief. The proposed plans, outlined in this bulletin, were submitted to the Parish Council by Sean Harrington Architects. The architects considered the requirements outlined in the brief and the history of Ringsend. After many constructive meetings, they submitted this modern design. Their interpretation of the Parish Council's brief was to design buildings that do not compete with the beauty of our Church, but which borrows ideas from the 100 year old design of our church and the history of the boat builders of Ringsend. It is a design that complements our church and our communities history. The council accepted the plans and planning permission has been submitted to Dublin City Council. The time-line for the planning permission is as follows:

- Date of submission of the planning application: **23.12.10**
- Site notice displayed until: **07.02.11**
- DCC notice of decision to grant/refuse permission: **28.02.11**
- Final notice of grant: **28.03.11 (if no appeals made)**

It is with great delight that the Parish Council present to you, our fellow parishioners the plans for the Parish Hall and Parish Office. The plans are outlined in this special edition of the bulletin and are also on view on the display boards at the back of the church. A model of the proposed buildings will soon be on display at the back of the church. We are extremely excited about this project and look forward to its completion in 2012.

# NEW PARISH HALL AND OFFICE

ST. PATRICK'S CHURCH, RINGSEND.

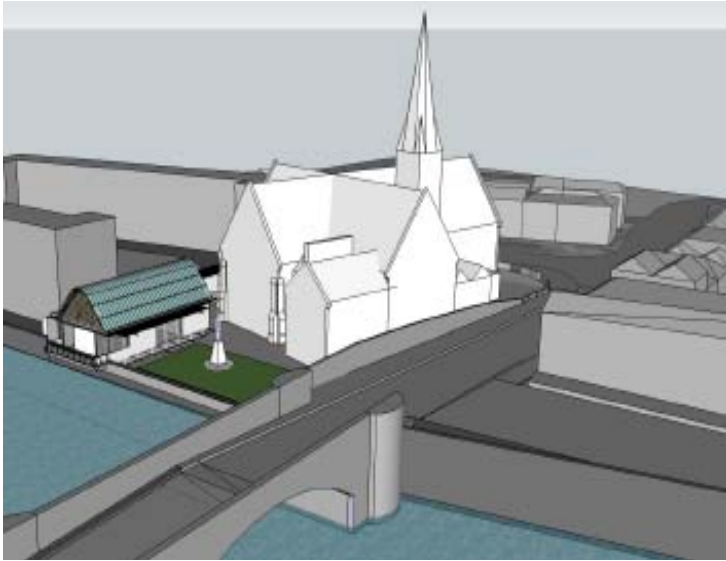

Sketch view looking at the proposed Hall from the Shelbourne Stadium side of the river.



Sketch view looking at the proposed Hall from the canal side of the river.

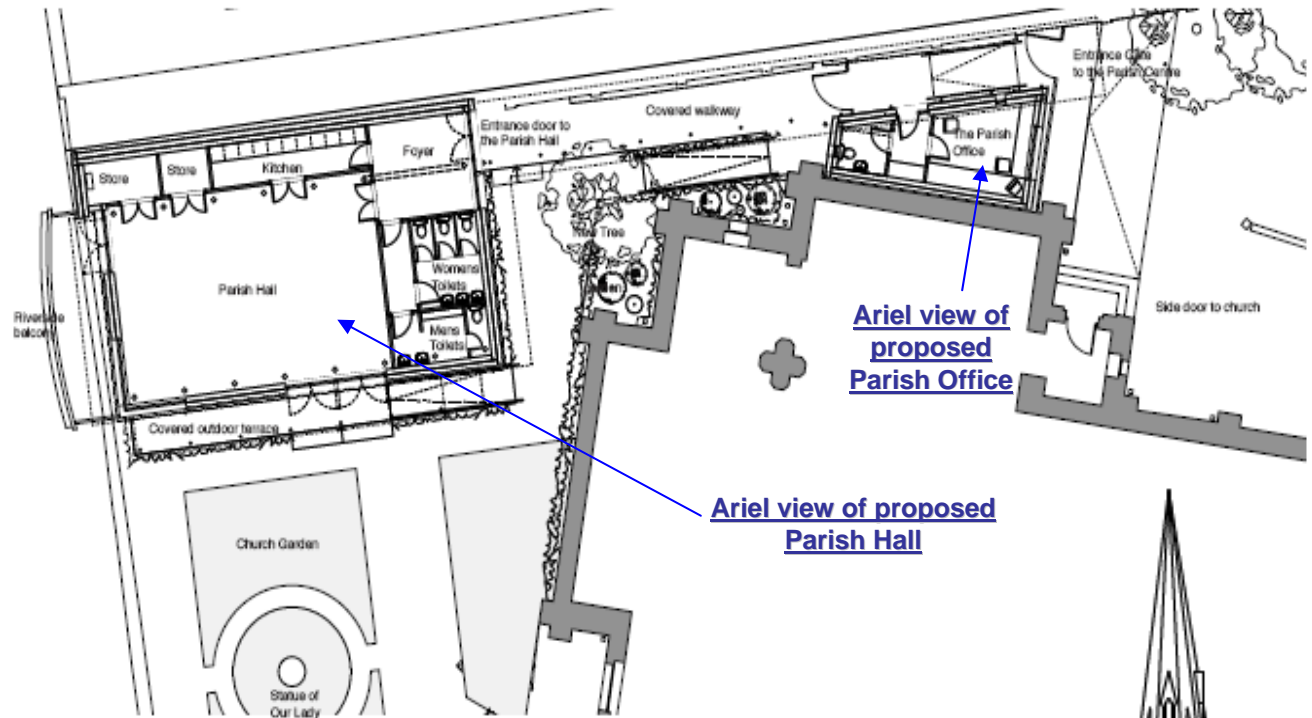

The new Parish Hall will overlook the River Dodder, Ringsend Bridge and the existing Church garden. The church garden is a great resource but is not used much. It has a wonderful riverside location, with the statue of Our Lady in the middle and gets the sun all day long. The parish Office will be to the side of the church and will overlook the Church forecourt and be like a "gatehouse" for the hall.

The entrance to the new parish centre will be to the right hand side of the Church, behind some beautiful decorative railings and the entrance will be clearly visible from Thorncastle Street. The colours of the gratings represent the colours of the blades of the oars from various rowing clubs that used the Dodder and the Liffey down through the decades.



View of proposed Parish Hall from the Back of the Church

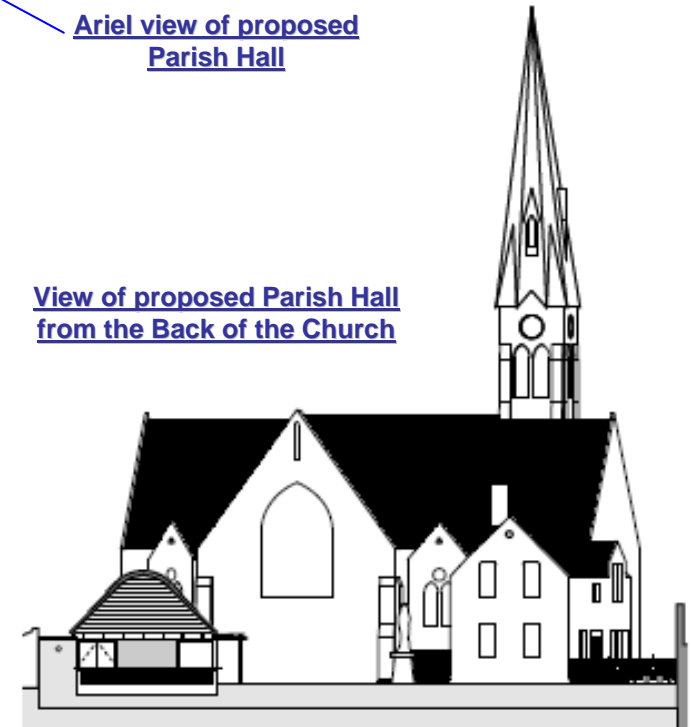

SEÁN HARRINGTON ARCHITECTS